

Reference	FM 4.72 Rev 1
Release Date	October 2013



Fire Protection Systems Information

60 minute Load-bearing Composite Deck

GRE/PVC Sandwich Panel Type

Fire towards Insulated Side Only

Profile Wrap System

Accompanies Method Statement FM-MS 05 PW and Design Information Sheet FM-DI-C01

Product	FireMaster Marine Plus Blanket & FireMaster Marine Plus ALU Blanket
Application Requirements	100mm thick lining applied in four layers as follows: <ol style="list-style-type: none"> 1. One layer 25mm FireMaster Marine Plus ALU Blanket 64 kg/m³ 2. Two layers of 25mm FireMaster Marine Plus ALU Blanket 70 kg/m³ 3. One layer of 25mm FireMaster Marine Plus Blanket 70 kg/m³ <p>See system drawing for exact configuration</p>
Anchoring	3 mm diameter screw-fixed steel anchors 12 to 25mm longer than blanket thickness. Friction fit retaining washers.
Weight	6.85 kg/m ² (applied to flat area)
System Drawing Reference	FM CAD06-4.72
System Features	<ul style="list-style-type: none"> • Fully fire tested as a load-bearing system under IMO MSC 45 (65). • Can be used on any sandwich panel design of greater strength
Certification	EU MED (DNV) DNV

Reference	FM 4.72 Rev 1
Date of Issue	October 2013

FMCAD06-4.72 IMO HSC Code - MSC 45 (65) 60 minute Loadbearing Composite Deck

COMPOSITE CONSTRUCTION

- 1600 g/m² Baxial 0/90
- 50mm Divinycell H80 core
- 1200 g/m³ Baxial 0/90
- Overall Thickness 52.8mm
- Iso Polyester resin tg=80 C

INSULATION CONSTRUCTION

FireMaster Marine Plus Blanket applied in four layers.

- Layer 1: 25mm thick 64 kg/m³ with layer of aluminium foil
- Layer 2 and Layer 3: 25mm x 70 kg/m³ with aluminium foil
- Layer 4: 25mm x 70 kg/m³ without aluminium foil

ANCHORING

Self drilling stainless steel anchors 3mm diameter with 25mm thread and 38mm diameter friction fit washers. Total length of anchor 155mm (125mm anchor shaft length + 30mm screw)

(Refer to Detail 'A')

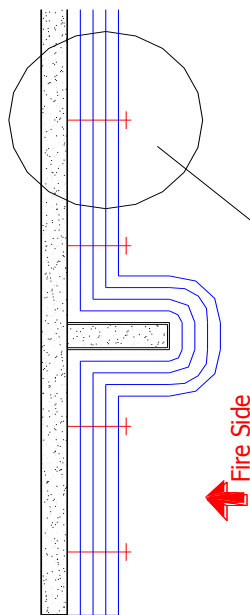
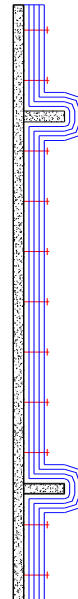
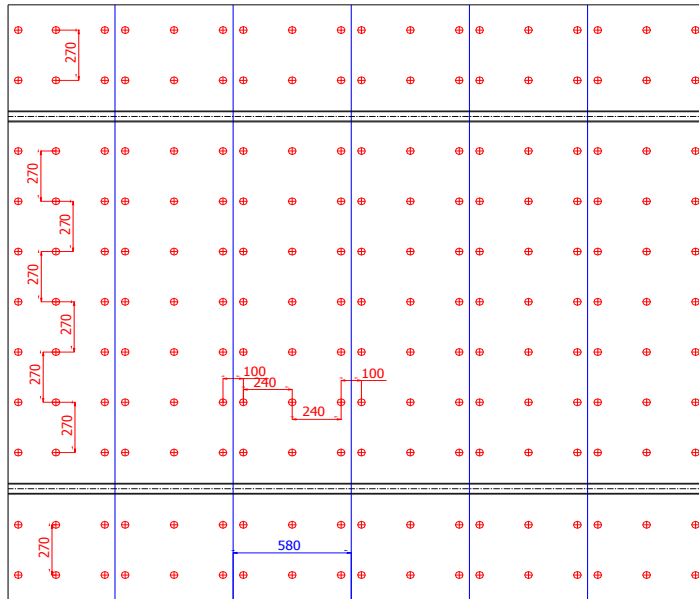

Detail "A"

